

# Configure DUO 2FA in Ezeelogin SSH Jump host

164 admin October 5, 2024 [Security Features](#), [Two Factor Authentication \( 2FA \)](#) 10569

## How to enable/disable DUO 2fa in Ezeelogin?

**Overview:** This article provides a comprehensive guide on configuring and managing Duo two-factor authentication (2FA) for Ezeelogin gateway users. It also covers methods to disable duo 2FA through both the GUI and backend commands.

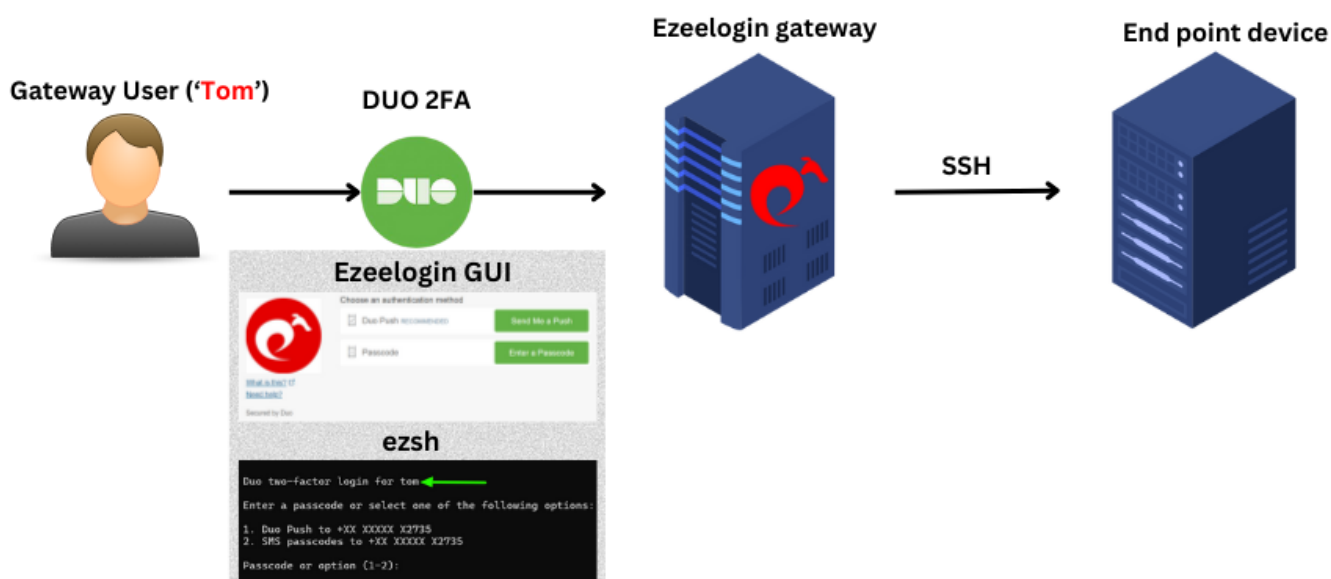

### Note:

Do check out the [duo ssh jump host configuration video](#) as well.

### 1. How to enable DUO 2FA (Two-factor Authentication) in Ezeelogin?

**Step 1(A):** Create your account on [duo.com](#) and log in. Navigate to **Applications -> Protect an Application**

**Step 1(B):** Search for **Web SDK** and click on **Protect this Application**

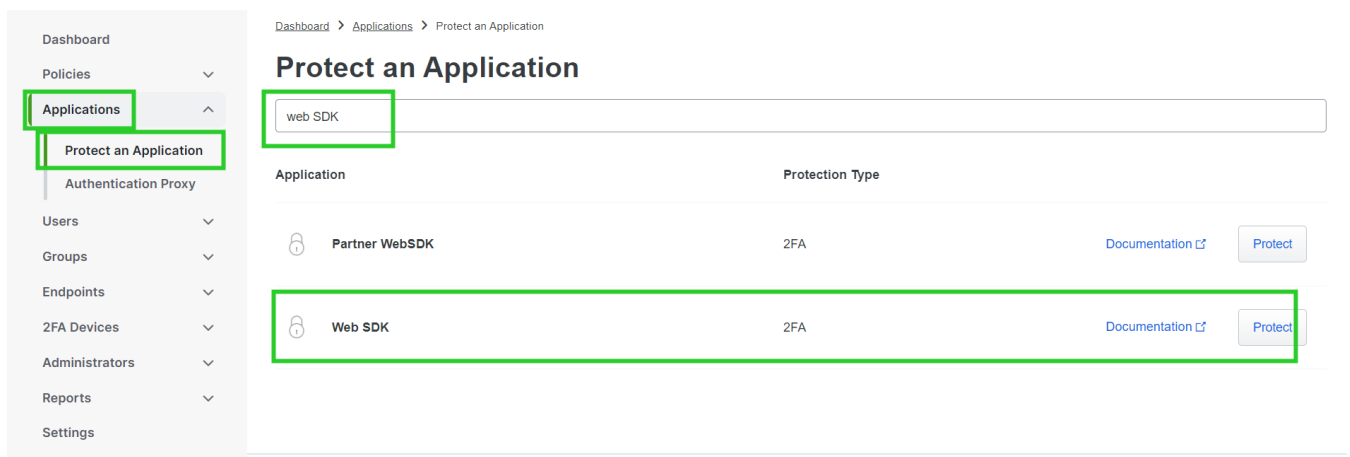

**Step 1(C):** Copy the **Integration Key**, **Secret Key**, and **API Hostname** and paste them on Ezeelogin GUI. Also, enter a custom name for this Application Under Settings.

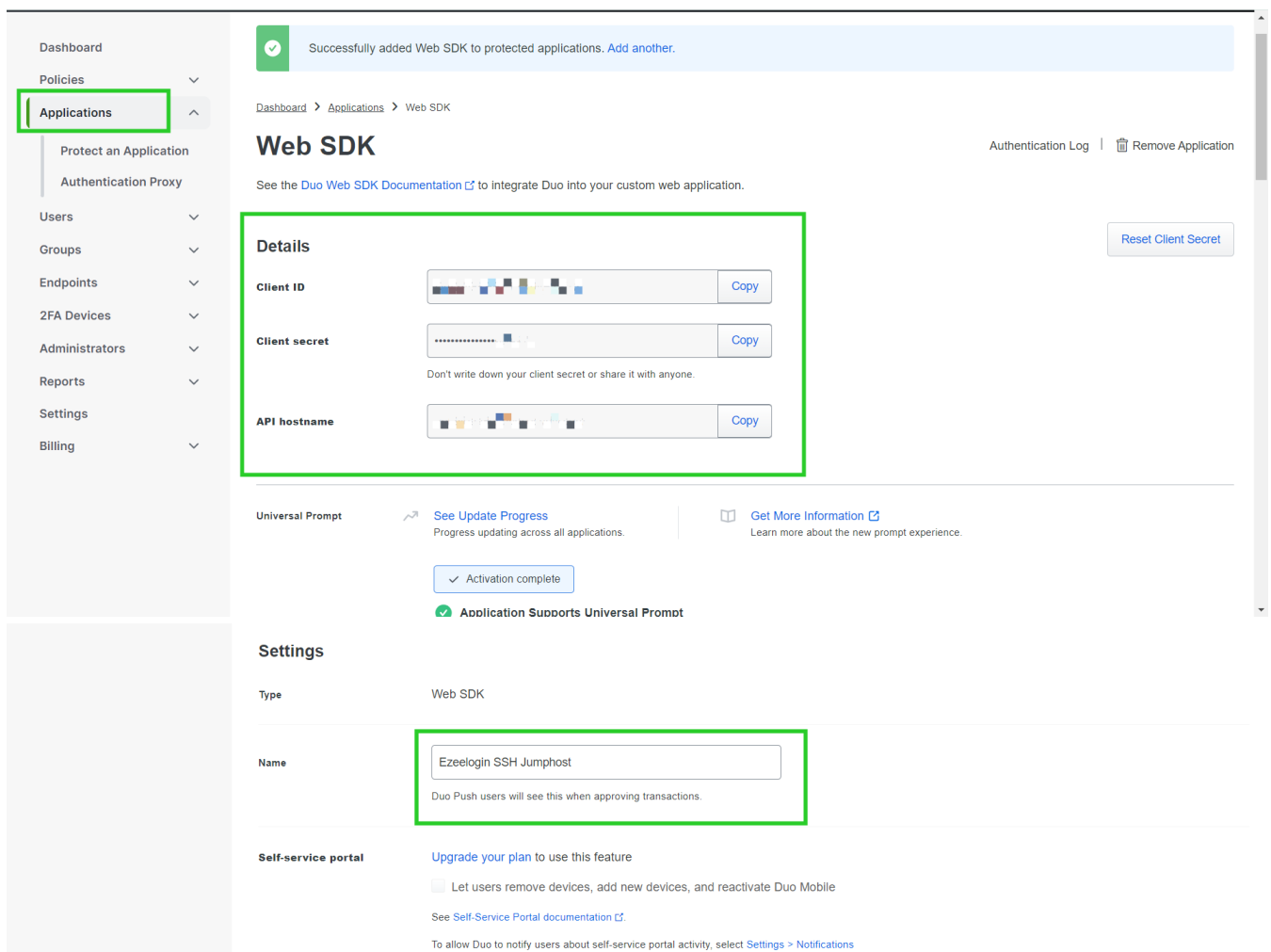

**Step 1(D):** Enable duo 2FA in the Ezeelogin GUI with an **admin privileged user**. Log in to the Ezeelogin GUI, navigate to **Settings -> General -> Two Factor Authentication -> Enable Duo**, and paste the **DUO Integration Key**, **Secret Key**, and the **API hostname** in the highlighted fields below, then click on the **save** button.

Note:

In order to avoid the " **invalid\_grant** " or " **An Error Was Encountered** "error, make sure to access the Ezeelogin GUI with SSL(HTTPS) and a domain name.

Refer to the article "error": "[invalid\\_grant](#)", "[error\\_description](#)"

The screenshot shows the Ezeelogin web interface. On the left is a sidebar menu with categories like Servers, Web Portals, Users, Access Control, Settings, Cluster, Command Guard, and Account. The 'Settings' menu is expanded, and 'General' is selected. The main content area is titled 'General Settings' and has tabs for Authentication, Two Factor Authentication, Security, Defaults, and Miscellaneous. The 'Two Factor Authentication' tab is active. It contains various settings for enabling Google Authenticator, Duo, Radius, Yubikey, and FIDO2. Several fields are highlighted with green boxes: 'Enable Duo' (checkbox checked), 'DUO Secret key' (text field with a long alphanumeric string), 'Force Two Factor Authentication' (checkbox checked), 'DUO Integration key' (text field with a long alphanumeric string), and 'DUO API hostname' (text field with 'api-9feaa8ef.duosecurity.com'). At the bottom right of the settings area are 'Cancel' and 'Save' buttons, with 'Save' highlighted by a green box.

**Step 1(E):** To set up Duo 2FA for user authentication, log in to the Ezeelogin GUI as the user for whom duo is to be **enabled**. Then, navigate to **Account -> Duo Authenticator -> Enable Duo Authenticator**.

The screenshot shows the Ezeelogin web interface with the 'Account' menu expanded and 'Duo Authenticator' selected. A modal dialog titled 'Enable/Disable Duo Authenticator' is displayed. It has a single button labeled 'Enable', which is highlighted with a green box. The background of the page is a textured, light brown color.

**Step 1(F):** Log out and re-login into the web panel and duo two-factor authentication will be asked.

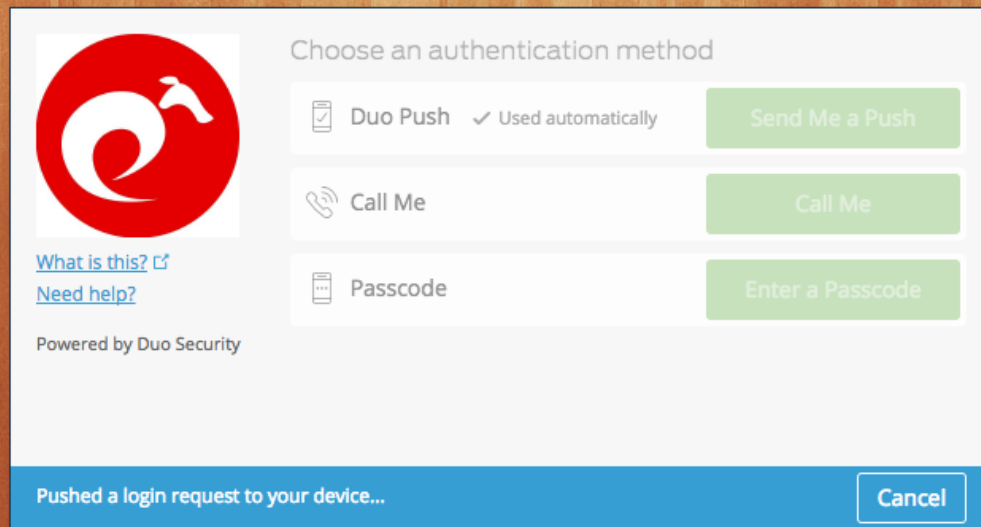

**Step 1(G):** The backend 2fa method will also be using Duo 2FA.

```
192.168.0.120 - PuTTY
Duo two-factor login for admin
Enter a passcode or select one of the following options:
1. Duo Push to +XX XXXXX X9825
2. SMS passcodes to +XX XXXXX X9825
Passcode or option (1-2):
```

Note:

If an Ezeelogin user wants to enable DUO 2FA, but Admin has disabled force two-factor authentication, then that particular user must log into the GUI and enable DUO 2FA under **Account -> DUO Authenticator** then logout and re-login again into the web panel and you would be asked for DUO two-factor authentication.

## 2. How to disable DUO 2FA (Two-factor Authentication) from the GUI?

**Step 2(A):** To disable Duo 2FA globally(Duo 2FA will be disabled for all users), navigate to **Settings -> General -> Two Factor Authenticator -> Disable Duo**

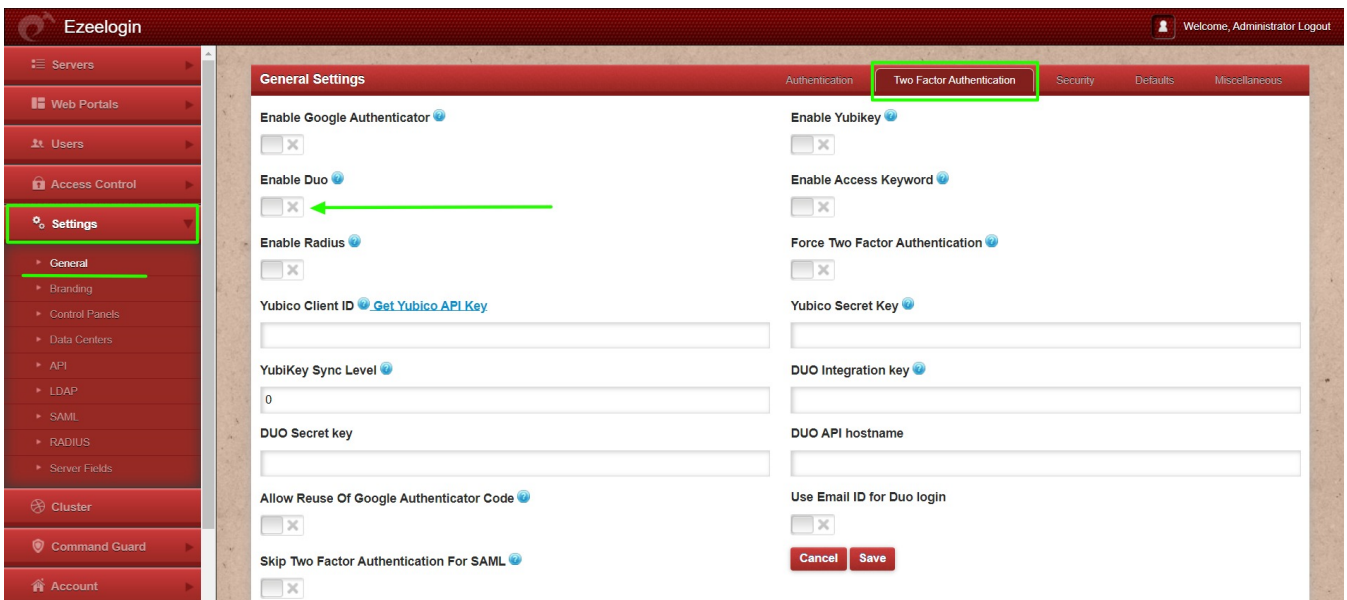

**Step 2(B):** To disable Duo 2FA for a **single user**, log in to the Ezeelogin GUI as the user for whom duo is to be **disabled**, navigate to **Account -> Duo Authenticator -> Disable**

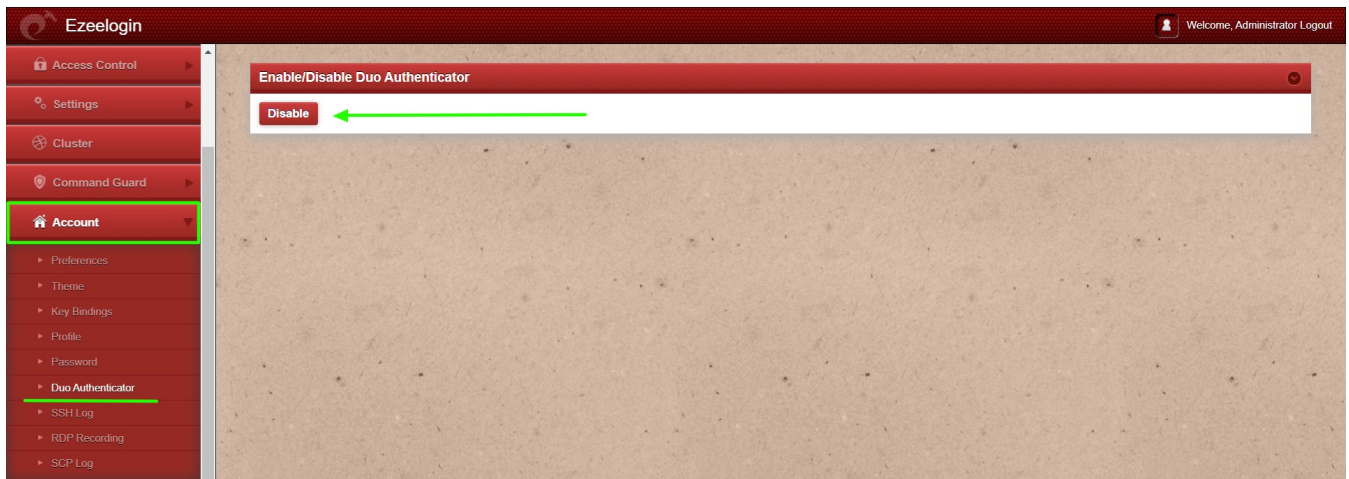

### Emergency CLI Method

Run the below commands to disable and clear DUO 2FA. Replace the username to disable DUO for that user.

```
root@gateway:~# php /usr/local/ezlogin/ez_queryrunner.php "update prefix_settings set value='N' where(name='enable_duo')"
```

```
root@gateway:~# php /usr/local/ezlogin/ez_queryrunner.php "update prefix_users set set_duo=0 where username='ezadmin'"
```

This error happens when we enforce Two-Factor authentication without enabling any of the Two-Factor authentications. Run the following command to disable **Force Two Factor Authentication**.

```
root@gateway:~# php /usr/local/ezlogin/ez_queryrunner.php "update prefix_settings SET value = 0 WHERE name = 'two_factor_auth'"
```

```
root@gateway:~# php /usr/local/ezlogin/ez_queryrunner.php "update prefix_usergroups SET force_tfa = 'N'"
```

---

### Related Articles:

[Enable/Disable two-factor authentication in Ezeelogin](#)

[Error: No Two-factor Authentication enabled in GUI](#)

[Disable two-factor authentication from the backend](#)

[How to reset the 2fa of an ezeelogin user?](#)

Online URL:

<https://www.ezeelogin.com/kb/article/configure-duo-2fa-in-ezeelogin-ssh-jumphost-164.html>